



22/11 Joy Cummings Place Belconnen ACT

3 2 2

This three bedrooms plus study executive townhouse is beautifully presented and immaculately maintained.

Located adjacent to Lake Ginninderra in the popular Canberra Lake Estate, this home has direct lake and walkway/cycle path access to just about everywhere.

On the ground floor this home has a spacious living area has defined dining and lounge rooms, a huge kitchen (with gas cooktop) and a separate laundry and powder room.

With very three large bedrooms, dedicated study area and generous storage throughout, this property will suit those looking for room top spread out!

The sunny position and ducted heating and cooling means year round comfort.

View : <https://www.borisproperty.com.au/lease/act/belconnen/belconnen/residential/townhouse/5703778>



Lee-Anne Radstaak
0402219727

GROUND FLOOR PLAN

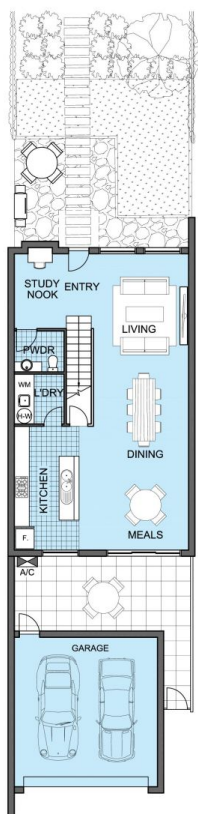

FIRST FLOOR PLAN

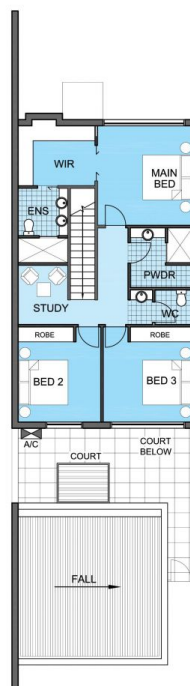

CANBERRA LAKE ESTATE

FLOOR PLAN TYPE

Unit Type 8

SECTION NAME: Section D
HOUSE NOS: 22, 23

LIVING AREA:
182m² & 183m²

GARAGE:
2

POOL:

30m x 15m x 1.5m

NOTE:

Unit entry varies left to right
Landscaping may vary on individual units.



This document / E Mail has been prepared by Colliers International and PRD Nationwide for advertising and general information only. Colliers International does not guarantee, warrant or represent that the information contained in this document is correct. Any interested party should undertake their own enquiries as to the accuracy of the information. Colliers International and PRD Nationwide excludes any liability for loss and damage arising from this document and excludes all liability for loss and damage arising from this document.