



BORIS.



BORIS.



BORIS.



BORIS.

1/28 Dominion Circuit Forrest ACT

4 2 2

Superbly located in the exclusive suburb of Forrest, this house sized town residence is just one of four in this boutique development. Positioned at the front with its own street entrance, and nestled behind lovely manicured gardens, this home offers a sunny, tranquil, private oasis with all the convenience and lifestyle the inner south has to offer. Manuka Village, Kingston and Lake Burley Griffin are all close by as is Forrest Primary School and Telopea Park School. Forrest tennis and bowls club are across the road.

The residence sprawls over three levels and offers 240m² of living with courtyards to the front, side and back. Oriented to the north-east, the home is drenched with sunlight.

Downstairs in the secure basement there is a large double garage with workbench and storage racks. There is another

Price : \$ 1,420,000
Building Size : 240 sqm
View : <https://www.borisproperty.com.au/sale/act/inner-south/forrest/residential/townhouse/5770181>



Boris Teodorowych
0402907182

BORIS.

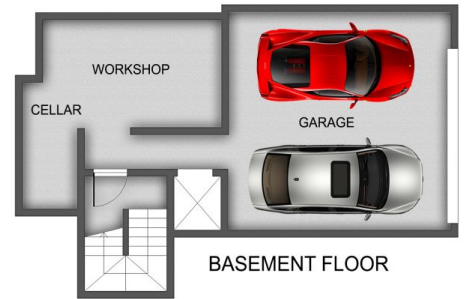

1/28 DOMINION CIRCUIT, FORREST

Disclaimer: This information has been provided to us from the vendor and or their conveyancer or solicitor, no guarantee is given in respect of its accuracy. Any person viewing this information should make their own enquiries and only rely on those enquiries.

LIVING 240m²
GARAGE/WORKSHOP/CELLAR 78sqm²