



202/24 Lonsdale Street Braddon ACT

2  2  2 

Cracking and modern two bedroom plus large study apartment in the heart of Braddon!

Walk out the door and you are in the centre of Canberra's most cosmopolitan street. Cafes, restaurants, bars and the city centre are all moments away- the lifestyle and convenience without peer.

This fantastic apartment offers segregated bedrooms and bathrooms either side of a large open plan living space with 3m ceiling and ducted reverse cycle air conditioning. The study is large enough to be a spare room or genuine home office. The master bedroom has a large walk-in-robe on the way to the ensuite. Both bedrooms have separate climate control air conditioning, perfect for those hot summer nights! The galley kitchen is functional, with stone bench tops. and includes a custom fit fridge and SMEG

Building Size : 95 sqm
Land Size : 5012 sqm
View : <https://www.borisproperty.com.au/lease/act/inner-north/braddon/residential/apartment/7366349>



Sarah Davies
0488 555 110

INTERNAL: 95m²

EXTERNAL: 36m²

TOTAL: 131m²

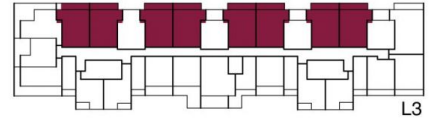

L3

NUMBER OF UNITS: 8

UNITS PER FLOOR

L2: 8

