





28/45 Freda Bennett Circuit Nicholls ACT

2  1  1 

Perfectly Positioned Single-Level Townhouse

This single-level townhouse, part of a boutique complex of tightly held homes, presents an outstanding opportunity for first home buyers, downsizers, or investors seeking a low-maintenance property in a desirable location.

Constructed in 1994 with solid brick veneer, the home offers the enduring quality of traditional building standards. Set in a peaceful pocket of Nicholls, it enjoys close proximity to local shops, schools, and golf clubs, ensuring both comfort and convenience.

Benefiting from a northerly aspect, the residence is filled with natural light and has been thoughtfully upgraded in

[For full version visit the website](https://www.borisproperty.com.au)

Type : Townhouse
Building Size : 73 sqm
View : <https://www.borisproperty.com.au/sale/act/gungahlin/nicholls/residential/townhouse/8518542>



Boris Teodorowych
0402219727



Lee-Anne Radstaak
0402219727

<https://www.borisproperty.com.au>

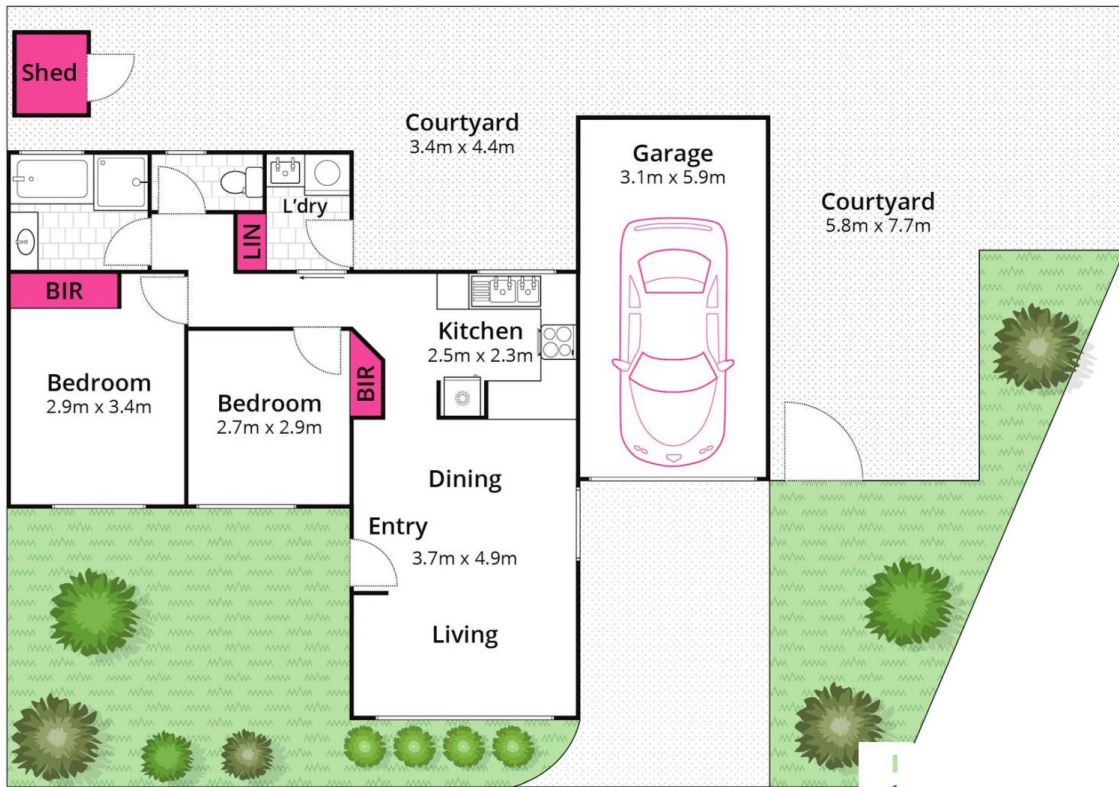

Whilst bwrn.com.au has made every attempt to ensure the accuracy of the floor plan contained here, measurements are approximate and no responsibility is taken for any error, omission, or mis-statement. This plan is for illustrative purposes only.

28/45 Freda Bennett Circuit, Nicholls

BORIS.
PROPERTY